

## APPLICATION

## SPECIFICATION

- Gas Appliance Directive (90/396/EEC)  
PIN: CE-0063AP3075/2



- **Normally Closed valve.**  
(spring loaded valve disc, closed when de-energized).
- **4 auxiliary pressure taps with Rp 1/4" threaded connections, 2 on the inlet pressure side and 2 on the outlet pressure side.**
- **Equipped at both sides with mounting holes to adapt a pilot solenoid valve combination Rp 1" (for DN100 Rp 3/4"), to allow either internal or external pilot gas. Optional mounting possibility to adapt an A4021A Valve Proving System.**
- **The VE5000C series have a special characterized valve plug which provides characterized opening for HI-LOW-OFF or modulating control.**
- **The valve remains tight when the actuator is replaced.**
- **Internal fine mesh screen (except DN100).**

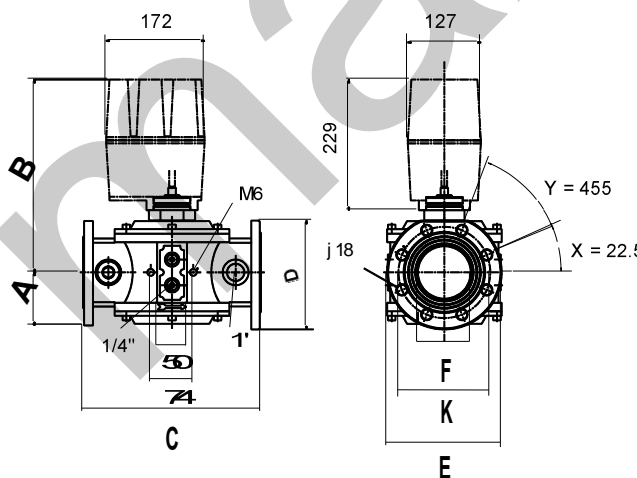

**Fig. 1. Dimensional drawing VE5000 Series**

**Table 1. VE5000A Series, overview.**

O.S Number	Passing DN	Maximum Operating Pressure (mbar) <sup>1)</sup>	Overall Dimensions (mm)							Weight (kg)
			A	B	C	D	E	F	K	
VE5065A3005	65	360	93	338	310	183	190	92	145	7.3
VE5080A3004	80	360	93	338	310	191	190	92	160	7.6
VE5100A3000	100	360	103	345	350	206	250	109	180	15

<sup>1)</sup> depending on the actuator  
K = diameter of bolt circle

Model	Connection	Capacity
VE5065A	DN65	123
VE5080A	DN80	155
VE5100A	DN100	270

capacity in m<sup>3</sup>/h air at np = 2,5 mbar  
(SG=1 at 1013 mbar, 15°)

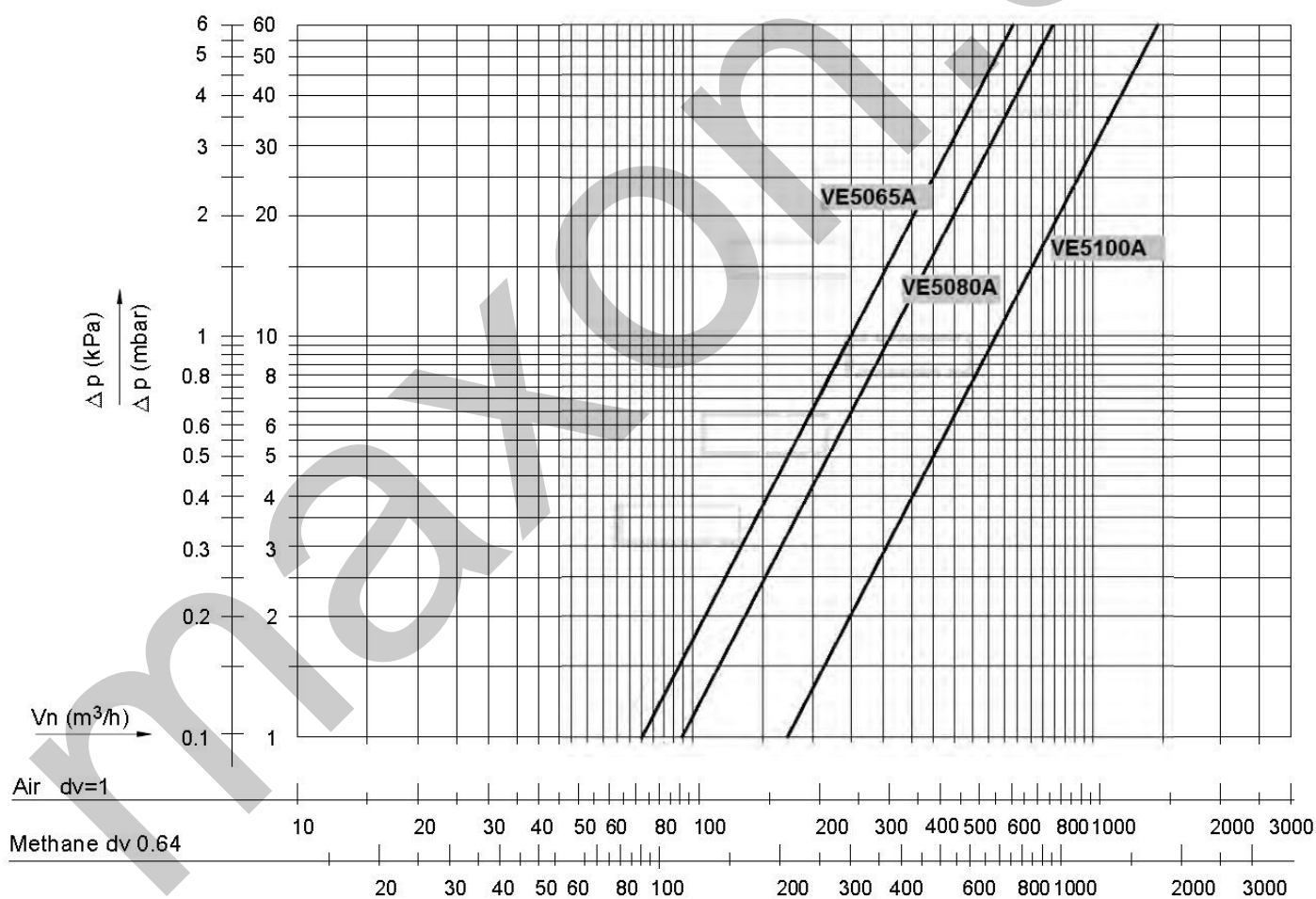

**Fig. 2. Capacity curves for VE5000A Series**